

TIMBERLAND

Collection

PRODUCT CHARACTERISTICS

- Profile with channel

The Rialux siding panels of the **Timberland Collection** are entirely composed of aluminum. The Rialux siding panels stand out due to their light weight properties, rust resistance and installation ease. The panels have a surface that resembles natural wood, which will surely enhance the look of your project.

PRODUCT DETAILS	DIMENSIONS
Length	150 inches
Height covered	5.45 inches
Thickness - depth	0.45 inches
Weight (per panel)	3.26 lbs
Screw holes	3/4 in x 1/8 in (19mm x 3.2mm)
Screw hole intervals	3 1/4 in (82.5mm)
Calibre	27 thousandth
Panel	1 panel = 5.68 ft ²

PACKAGING	
Quantity per box	20 panels of 150 in (3658mm)
Area covered	113.6 ft ²
Box dimension	151 x 7 x 4.5 inches
Box weight	73 lbs

NOTE

Please refer to the building codes for installation details.

NOTE

Rialux **Timberland Collection** panels are composed of many different shades in every color offered. Therefore, it is extremely important to mix the shades during installation to ensure an even distribution of the different shades throughout the surface. Make sure to validate that the results are satisfying every 3 or 4 rows installed.

INSTALLATION SURFACES

- On wood furring (16 inches center to center)
- On metal furring (16 inches center to center)

DIRECTIONS OF INSTALLATION

- Horizontal laying
- Vertical laying
- Diagonal laying

FIXING PROCEDURE

- Screw every 16 inches in the middle of each opening provided for this purpose. Use a 1.25 inches in length screw. See page 6 for screw details.
- Overlap the profile panels of 12.6 in. ft with the notches on the installation surface.
- When cutting is necessary, it is highly recommended to cut the length of the panels with the appropriate tools suggested by Rialux.

TIMBERLAND

Collection

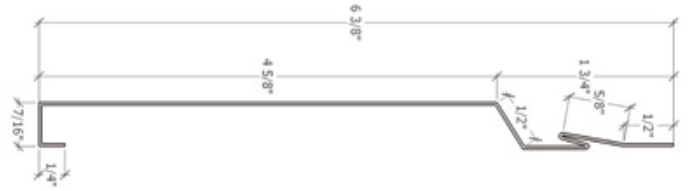

SCREWS

Screw in the middle of each opening provided for this purpose and in a moderate way. It is important not to use pressure towards the bottom or the top while screwing. Make sure that the result is satisfying every 3 or 4 rows installed. To ensure installation quality, remove the protective film from the coating throughout and make corrections if necessary.



TYPE OF SCREW: INOX #8
LENGTH: 1.25 INCHES
HEAD SIZE: #8 - STAR

ASSEMBLY

Join Rialux Aluminum siding panels across their width:
 Joining panels across their width by using clips to cover and protect the screw holes.

Join Rialux Aluminum siding panels across their length:
 Joining panels along their length by superimposing the notches provided for this purpose at the ends of the siding panels.

MATERIAL VERIFICATION

The contents of every box must be inspected upon reception. All material installed constitutes acceptance of product.

MOULDINGS AND ACCESSORIES

Mouldings such as starter trim, drip mouldings, QJ trim and inside / outside corners are available from the Rialux Aluminum Siding manufacturer.

The starter trim must be carefully levelled and installed as an invisible clip at the bottom of the wall behind Rialux panels. The installation of drip moulding is required to divert water around windows and doors.

HANDLING BOXES

Lift each ends of the box, holding it straight at all times. Do not lift the box by the center as it may deform or damage the product.



COULEURS

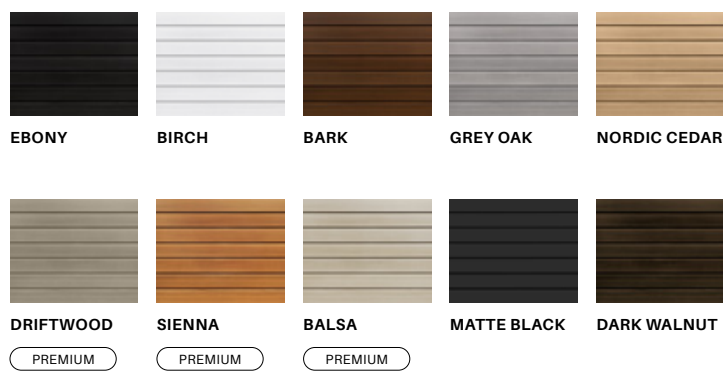

FIRE RESISTANCE

The aluminum siding panels of the Rialux **Timberland Collection** are classified as a zero flammability hazard, according to the NFPA Rating Rating Explanation Guide.

ACCESSORIES

Collection

Starter strip

TIAGO

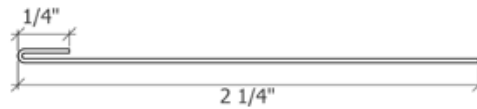

PRODUCT DETAILS	DIMENSIONS
Length	120 inches
Weight (per panel)	1 lbs
Calibre	27 thousandth

TIMBERLAND



PRODUCT DETAILS	DIMENSIONS
Length	120 inches
Weight (per panel)	1 lbs
Calibre	27 thousandth

ACCESSORIES

Collection

J-Trim - window

TIAGO - TIMBERLAND

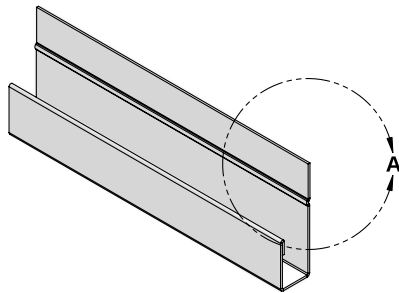

PRODUCT DETAILS	DIMENSIONS
Length	120 inches
Weight (per panel)	1 lbs
Calibre	27 thousandth

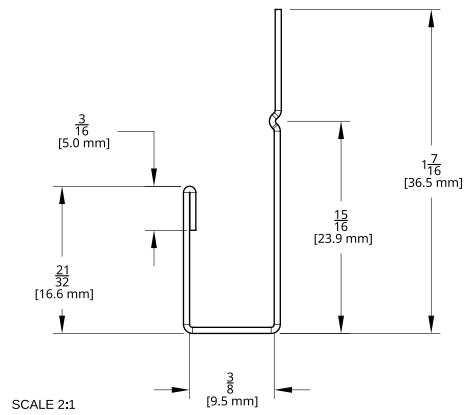
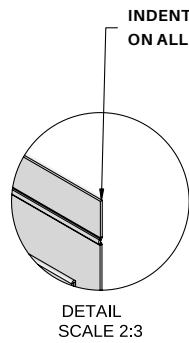

Drip cap

TIAGO - TIMBERLAND - BOLTON

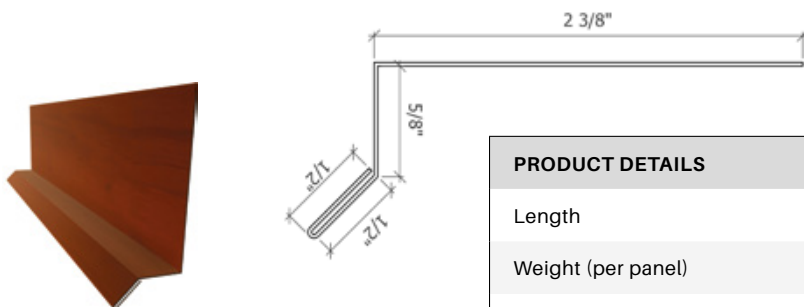

PRODUCT DETAILS	DIMENSIONS
Length	120 inches
Weight (per panel)	1.5 lbs
Calibre	27 thousandth

ACCESSORIES

Collection

Interior corner

TIAGO - TIMBERLAND - BOLTON

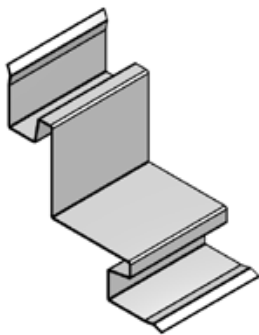

PRODUCT DETAILS	DIMENSIONS
Length	120 inches
Weight (per panel)	3.5 lbs
Calibre	27 thousandth

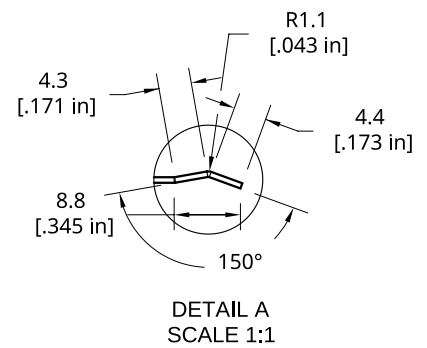
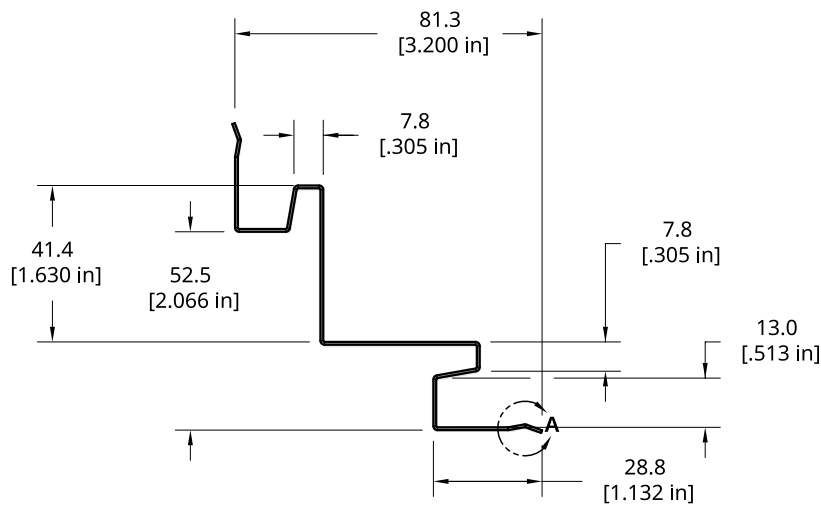

ACCESSORIES

Collection

Exterior corner

TIAGO - TIMBERLAND - BOLTON

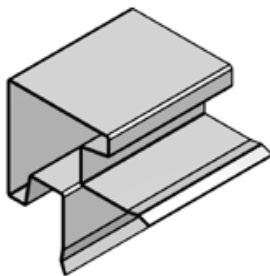

PRODUCT DETAILS	DIMENSIONS
Length	120 inches
Weight (per panel)	3.5 lbs
Calibre	27 thousandth

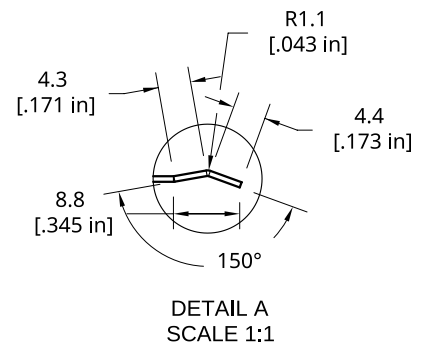
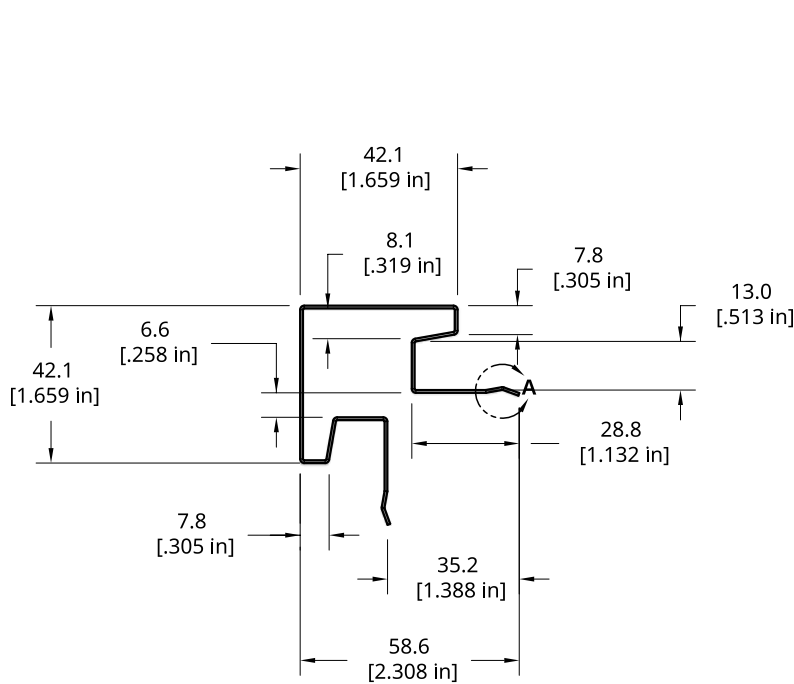

ACCESSORIES

Collection

Soffit

TIAGO - TIMBERLAND - BOLTON



PRODUCT DETAILS	DIMENSIONS
Length	150 inches
Weight (per panel)	3.26 lbs
Calibre	27 thousandth

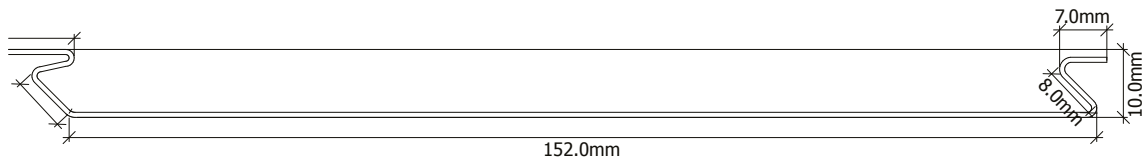

RIALUX

ALUMINUM SIDING



Table of contents

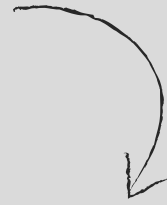

IMPORTANT NOTE

SEALING BARRIER	P_03
BOX HANDLING	P_04
CONTENT VERIFICATION	
WALL PREPARATION	
NEW CONSTRUCTION	
NECESSARY TOOLS	P_05
INSTALLATION SURFACES	
INSTALLATION DIRECTION	
COLOR SHADES	P_06
CUTTING	P_07
ACCESSORIES INSTALLATION	
TRACING A CHALK LINE	P_08
STARTER MOLDING	P_09
SCREWS	P_11
PANEL EXPANSION	P_12
DRIP MOLDING	
J-MOLDING	
INSTALLATION OF MOLDINGS AROUND WINDOWS AND DOORS	
EXTERIOR AND INTERIOR CORNERS	P_13
INSTALLATION OF DRIP MOLDING AND J-MOLDING ON CONCRETE WINDOW SILL	
INSTALLATION OF HORIZONTAL PANELS	P_14
INSTALLATION OF VERTICAL PANELS	P_16
INSTALLATION OF BOLTON	P_18
INSTALLATION ON GABLES	P_20



IMPORTANT NOTE

Sealing barrier

Rialux siding is an outer siding and not a sealing barrier. It is designed to let the material, on which it is laid on, breathe. However, it is a rain screen that reduces the amount of water that can reach the underlying sealing barrier.

Water resistant barriers are usually made up of a group of components including an exterior siding such as aluminum siding, sealing strips that cover openings and water penetration, a waterproof barrier and another type of intermediate siding.

An effective exterior cladding system first lets water flow to the surface, controls the flow of moisture by capillarity and diffusion and minimizes its absorption into the wall structure.

The degree of waterproofness required is determined by the applicable building code, structure and climate. Remember that using additional measures can provide better protection against water infiltration than simply complying with the minimum building code requirements.



Box reception

Box handling

Two people are required to lift the box, one at each end, and the box must be held straight. To avoid damaging the product, do not lift the box by the middle.



Content verification

Please inspect the contents of the boxes when receiving the material. Any material installed will be considered acceptance of the product.

Wall preparation

The waterproofing barrier must be placed on the house before installation. If it is not already in place, an exterior cladding system will be installed afterwards.

New construction

The aluminum siding must be installed on a rigid intermediate coating, OSB type or Tentest (black insulating fiberboard) with sealing barrier and installation of furring strips. Consult the local building code for specific requirements in this regard. The exterior siding must never be placed directly on the pillars of the frame, without intermediate cladding or without a sealing barrier and furring strips.

Necessary Tools

To install the Rialux panels you will need the following tools:

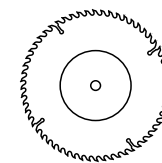

Miter saw with finishing blade

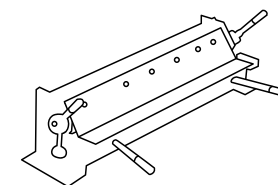

Folding machine (optional)

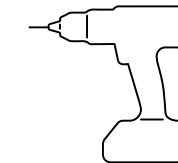

Screwdriver & Drill

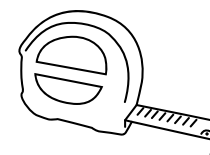

Tape Measure



Level

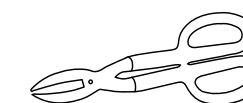

Sheet metal chisel

INSTALLATION DIRECTION

- Horizontal
- Vertical
- Diagonal

INSTALLATION SURFACES

- On furring strips (16 inches center to center)
- On metal slats (16 inches center to center)

Example of arrangement

*FOR INFORMATION PURPOSES ONLY

RED

GREEN

ORANGE

YELLOW

PINK

BLUE

COLOR SHADES

4 to 6 shades

Rialux products have four to six distinct shades for each color offered. It is therefore very important to mix the boxes to ensure an even distribution of the different shades of colors on your installation surface.

Please remove the color protective film AFTER the panel is installed and be sure to validate that the visual result is satisfactory for each 3 to 4 rows installed.



Cutting

To cut the exterior siding, soffits and aluminum accessories, use the following tools:

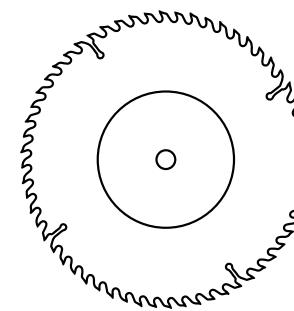

Circular saw with a thin-teeth blade or inverted plywood blade

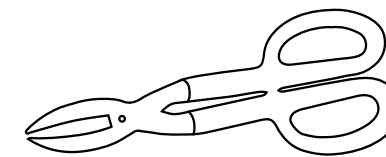

Shears

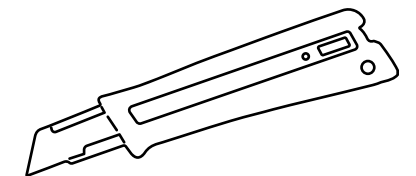

Knife with retractable blade

Groove the outer face of the aluminum, making sure that the blade of the knife is sharpened. Carefully, bend the aluminum in both directions until it splits along the groove.

Caution :

Wear goggles throughout this operation

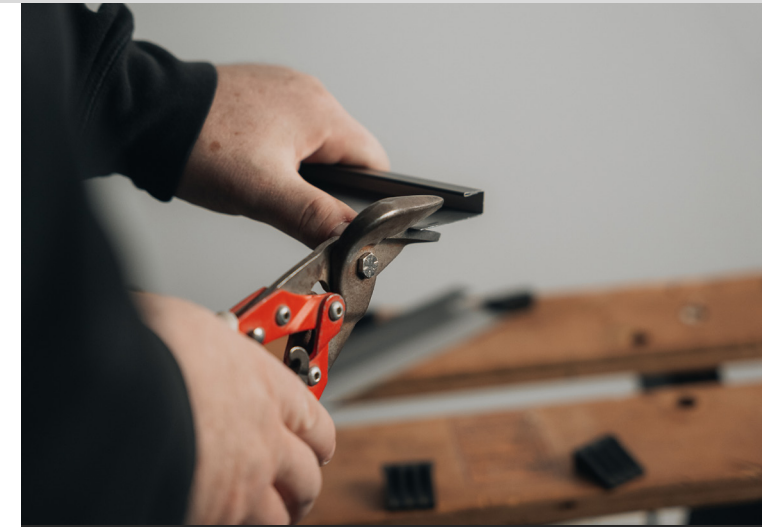

Tracing a Chalk line



To properly install the siding, it is important to draw a straight reference line to position the starter strip.

- From the lowest corner of the walls to be covered, measure upwards to establish the point that will correspond to the top of the starter strip.
- Using a tape measure, draw a cord line from the starting point to the end of the wall to be covered. (In some cases, it may also be possible to measure downwards from the overhang (freeze) to establish this line.)

Starter molding



Draw a line using a level or chalk marker. Attach the starter molding, making sure it is level. Use the holes provided for this purpose.

Starter molding
Tiago



Starter molding
Timberland

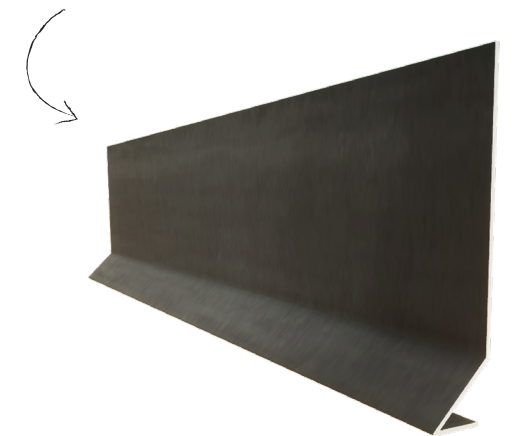



Screws

Screw every 16 inches into the holes provided for this purpose. It is recommended to use the stainless steel screws available at Rialux that are 1.25 inches long. The screws must be screwed **into the centre of the openings** provided for this purpose and in a moderate manner. **It is important not to exert pressure upwards or downwards.**

If necessary, it is possible to drill additional openings on the aluminum panel with the appropriate tool so that the openings align with the screwing surface.

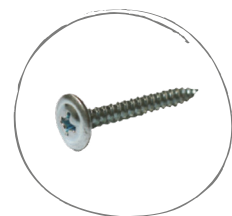

Screw Type: Inox #8
 Length: 1.25 inches
 Head: #8 - Star

Panel Expansion

Depending on the temperature during installation, you must provide spacing for the expansion and contraction of the panels. It is therefore important to provide a spacing of about 1/8 inches to 1/4 inches. Always plan to lock the panel joints on a wooden slat in the wall, so they do not move in the joint. Never attach this furring strip to the wall because it must keep its mobility to allow for the expansion at the ends.

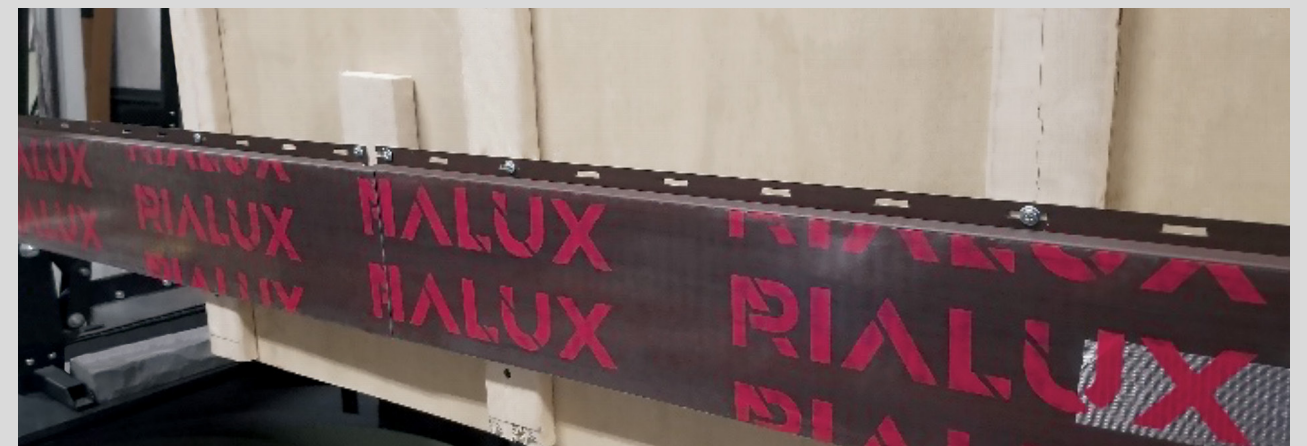

Moldings

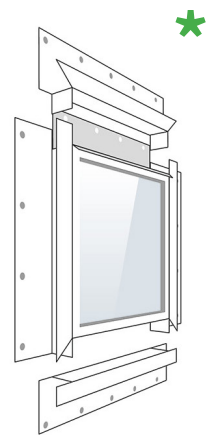

Drip molding

Drip molding should be installed above the frame of windows and doors.

J-Molding

Install the J-molding, on all three sides of the window (left, right and below). Next, install a drip molding above the window frame and install a J-Molding on the top drip molding.

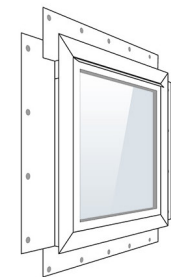

Installation of moldings around windows and doors

- Install J-moldings around windows, doors and all openings as shown below, nailing them at intervals of 8 to 12 inches. Start at the bottom, then on either side of the opening and finish at the top.*
- Be sure to make drip tabs at the ends of the top moldings.

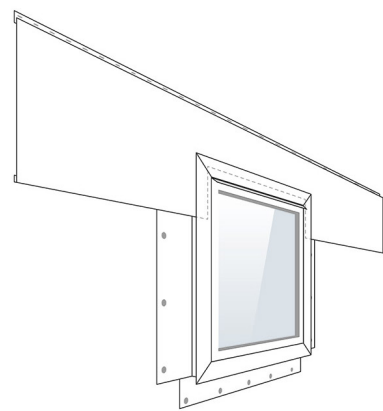

Exterior and interior corners

- Make sure the wall studs are straight. If necessary, draw a chalk line.
- Secure the stud by placing the fasteners in the center of the slots at intervals of 8 to 12 inches.
- Leave a 3/8 inch space at the bottom if the stud is to cover concrete, deck rooms, etc.
- If you need to use more than one length of corner piece, remove 1 inch from the nail strip and the receiver pouch of the top piece. Overlap the stud by 3/4 inch.*
- You can make the inner corners using two J-moldings placed back to back or a J-molding placed against the cladding of the adjacent wall.

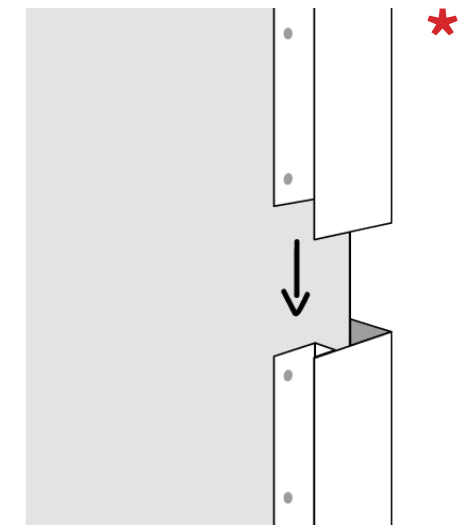

Installation of Drip molding and J-Molding on concrete window sill

1. Install drip molding on concrete window sill
2. Perforate a J-molding
3. Install J-molding in drip molding

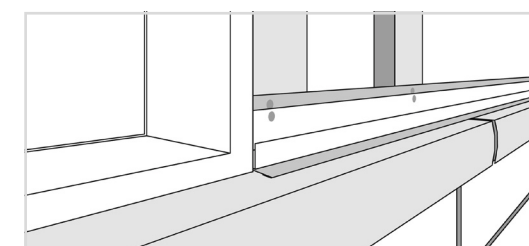
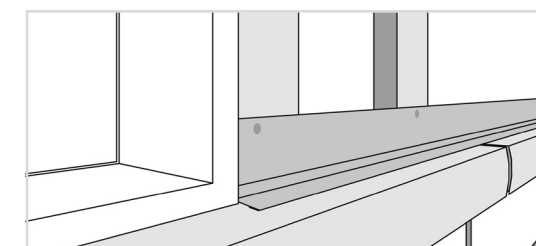
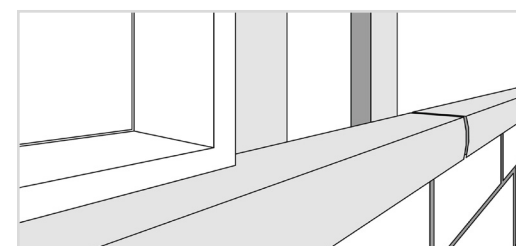
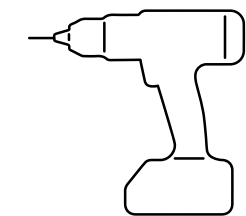

Installation of horizontal panels

1. Proceed with installing the J-trim starter at the bottom of your wall by pre-drilling the trim to allow water drainage before its installation.
2. Install the first panel by pushing the bottom of the panel into the starting starter. Adjust to leave a space of about 1/4 inch in the corner. Attach the panel to the center of the slots, leaving 1/32 inch between the fastener and the panel to allow the panel to expand and contract. Place fasteners at intervals of up to 16 inches.
3. Continue to install the first row by overlapping the panels by 3/4 inches. The end that is cut in the construction site must always be placed in the corner molding or the J-molding.
4. Install the other rows, making sure to shift the joints randomly so that they are ideally at least 24 inches apart to be less visible. Do not make a joint immediately below or above a window or door opening. Joints should never be aligned without being separated by at least a few rows.



NOTE: Make sure to overlap joints away from entrances and high traffic areas and always overlap joints from farthest to nearest. For example, always start from the back of the house to the front to reduce the appearance of the joints.

Leave about 1/4 inch at all ends of the panels to allow them to expand. For example, when measuring a panel to be placed between two windows, subtract 1/2 inch from the exact distance between the sides of the two windows.

- When measuring the dimensions to install a panel above a window or door, add 3/8 inch so that the locking tab can be well engaged in the panel below.



Each panel of the Timberland and Tiago, Bolton collection has a unique attachment system for additional stability.

Tiago
*Timberland

Vertical panel installation



1. The installation of Bolton panels should be done on double furring strips, with the first one oriented vertically and the second one horizontally.
2. Install the drip molding at the bottom of your wall, making sure to place it behind the furring strips and the weather barrier. Then, proceed with installing the J-trim starter by pre-drilling the trim to allow water drainage before its installation.
3. Install the first panel by pressing the bottom into the starter trim and adjusting to leave approximately a 1/4-inch gap at the corner. Secure each panel at the center of the screw slots, leaving a 1/32-inch space between the fastener and the panel to allow for expansion and contraction. Place the fasteners at a maximum interval of 16 inches.
4. Continue the installation by overlapping the panels by 3/4 inch. Always ensure that the vertical panel joints overlap those of the lower row to prevent water infiltration.
5. Install the other rows, making sure to shift the joints randomly so that they are ideally at least 24 inches apart to be less visible. Do not make a joint immediately below or above a window or door opening. Joints should never be aligned without being separated by at least a few rows.
6. To finish your wall, measure the distance from left to right at the top of the wall. Cut the J-trim molding to this measurement and secure it in place using screws.

NOTE:

- If you need to cut the panels to fit the width of the wall and finish them with a J-trim, an outside corner, or an inside corner, it is essential to cut the panel with a margin of 3/4 inch wider than the intended width. Then, fold this 3/4 inch margin at a 90-degree angle outward from the wall. In areas exposed to strong winds, adding a sealing joint can prevent panel detachment.
- When measuring dimensions for installing a panel above a window or door, add 3/8 inch so that the locking leg can properly engage in the panel below.



Each panel of the Timberland and Tiago, Bolton collection has a unique attachment system for additional stability.



*For the vertical installation of the Timberland profile, please consult a specialized installer.

Bolton panels installation

1. The installation of Bolton panels should be done on double furring strips, with the first one oriented vertically and the second one horizontally.
2. Install the drip molding at the bottom of your wall, making sure to place it behind the furring strips and the weather barrier. Then, proceed with installing the J-trim starter by pre-drilling the trim to allow water drainage before its installation.
3. Install the first panel by pressing the bottom into the starter trim and adjusting to leave approximately a 1/4-inch gap at the corner. Secure each panel at the center of the screw slots, leaving a 1/32-inch space between the fastener and the panel to allow for expansion and contraction. Place the fasteners at a maximum interval of 16 inches.
4. Continue the installation by overlapping the panels by 3/4 inch. Always ensure that the vertical panel joints overlap those of the lower row to prevent water infiltration.
5. Install the other rows, making sure to shift the joints randomly so that they are ideally at least 24 inches apart to be less visible. Do not make a joint immediately below or above a window or door opening. Joints should never be aligned without being separated by at least a few rows.
6. To finish your wall, measure the distance from left to right at the top of the wall. Cut the J-trim molding to this measurement and secure it in place using screws



NOTE:

- If you need to cut the panels to fit the width of the wall and finish them with a J-trim, an outside corner, or an inside corner, it is essential to cut the panel with a margin of 3/4 inch wider than the intended width. Then, fold this 3/4 inch margin at a 90-degree angle outward from the wall. In areas exposed to strong winds, adding a sealing joint can prevent panel detachment.
- When measuring dimensions for installing a panel above a window or door, add 3/8 inch so that the locking leg can properly engage in the panel below.



Each panel of the Timberland and Tiago, Bolton collection has a unique attachment system for additional stability.

Installation on gables

Before installing exterior siding on a gable, the J-trim must be installed to accommodate the siding at the ends of the gable.*

- When meeting left and right sections at the top of the gable, let one of the sections end up in the top while the other section overlaps it.
- Make a bevel cut on the front wing of this piece for a better appearance.
- Fix the J-molding at intervals of 8 to 12 inches

To install the cladding panels, make a template that reproduces the angle of the gable:

- Insert a short piece of cladding into the starting row of the gable (i.e., the last row before the start of the gable).
- Hold a second piece of cladding against the J-molding at the inclined end of the gable. Mark the angle with a pencil stroke on the short piece.*
- Remove the short piece and cut it along the pencil line to make it a template from the angle of the gable. Repeat the procedure on the other side of the gable. Check the cut template after a few rows.
- Attach the last panel to the top of the gable using a finishing nail of the color of the siding.*

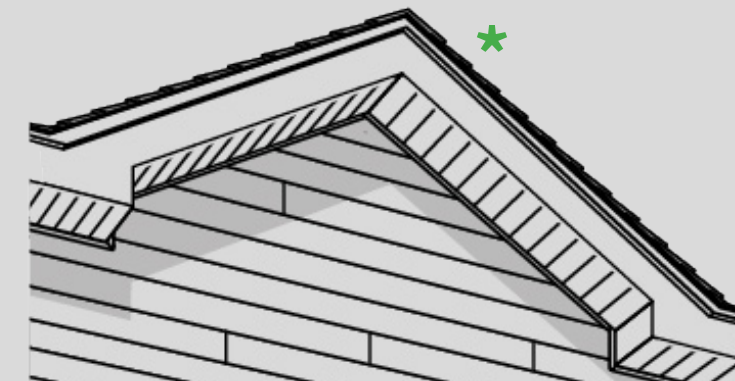
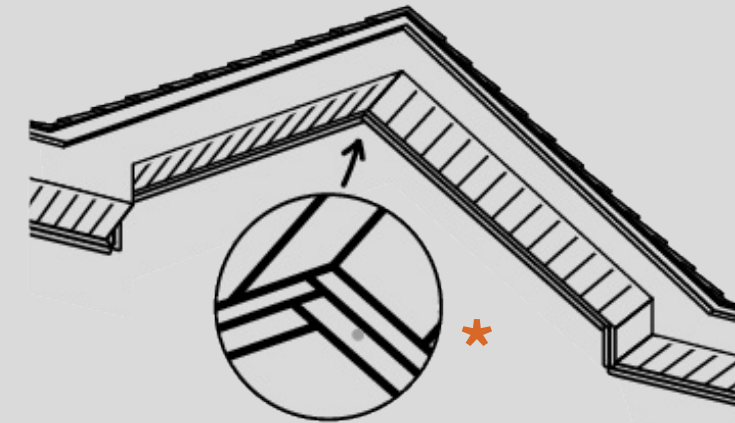

RIALUX

ALUMINUM SIDING

DIVISION OF THE RINOX GROUP
rinoxgroup.com



RIALUX.COM

